



- 开启角度: 95度
- 铰杯厚度: 9.5毫米
- 铰杯直径: 26毫米
- 面板(K)尺寸: 3毫米-5毫米
- 材质: 铁镀锌
- 门可选用板厚: 12毫米-18毫米
- Opening angle: 95°
- Depth of hinge cup: 9.5mm
- Diameter of hinge cup: 26mm
- Drilling distance on the door(K): 3-5mm
- Material: cold rolled steel, nickel plated
- Range of door thickness: 12-18mm

E26系列(普通型)自关铰链功能图 E26 Installation dimensions

D: 盖位计算值表 Overlay
A: 间隙位计算值表 Gap



E26A 全盖 Full overlay

$$H = 11.5 + K - D$$

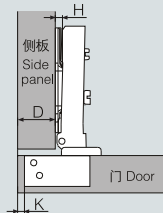

H \ D \ K	K		
	3	4	5
0	14.5	15.5	16.5
2	12.5	13.5	14.5
4	10.5	11.5	12.5



E26B 半盖 Half overlay

$$H = 2.5 + K - D$$

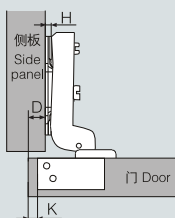

H \ D \ K	K		
	3	4	5
0	5.5	6.5	7.5
2	3.5	4.5	5.5
4	1.5	2.5	3.5



E26C 内嵌 Insert

$$H = -4 + K + A$$

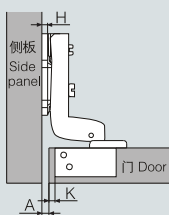

H \ A \ K	K		
	3	4	5
0	1	0	-1
2	3	2	0
4	5	4	2

铰杯种类 Hinge cup types

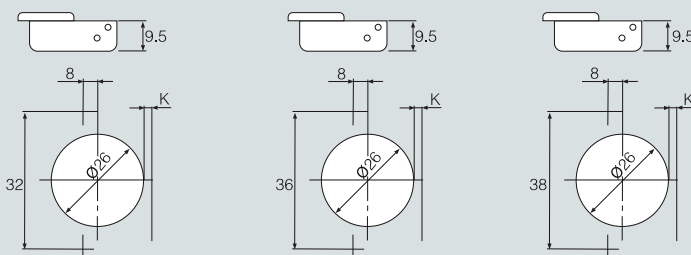

可配底座 Plate

序号 No	名称 Item no.	H值 H Value	孔型/安装尺寸L Hole type/Mounting dimension	类型 type
1	E20/E22	H=0/2	两孔two holes/37mm	普通Normal
2	E40/E42	H=0/2	四孔four holes/37mm	普通Normal
3				

安装尺寸L(Mounting dimension L)

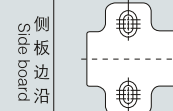

安装尺寸L(Mounting dimension L)

